



# Fan Jet Pro Plus

## 65 & 130

### Original Operating Manual and Parts List



**Read carefully before installation  
and operation**

This document must not be copied duplicated or distributed without prior consent .  
All and patent rights apply

**STOCKS AG LIMITED, CROMWELL ROAD, WISBECH, CAMBRIDGESHIRE, UK.**

Tel: 00 44 (0) 1945 464 909 Email: [sales@stocks-ag.co.uk](mailto:sales@stocks-ag.co.uk) [www.stocks-ag.co.uk](http://www.stocks-ag.co.uk)

# Index

Section		Page No.
2	Index	2
3.1	General information	3
3.2	Technical data	3
3.3	Intended use	3
3.4	Unintended use	3
4.1	Contents of the EC Declaration of Conformity	4
4.2	Contents of the UKCA Declaration of Conformity	5
5.1	Machine identification	6
5.2	Warranty	6
6	Safety	7
7.1	Emergency Stop Instructions	8
7.2	Maintenance	8
8	Safety warning decals and safety signs	9
9.1	Clearing a blockage	10
9.2	Hopper Removal	10
9.3	Storage	10
9.4	OPTIONAL Heavy Duty Waterproof Cover	10
9.5	Disposal	10
10.1	Fitting to a vehicle or implement	11
10.2	OPTIONAL ATV Fitting Kit	11
10.3	OPTIONAL UTV Fitting Kit	11
11	Mounting Plate	12
12.1	Electrical Components	13
12.2	Electrical Connections	13
13	Control Panel	14
14.1	Setting the spread bias	15
14.2	Setting the headland deflectors	15
14.3	Spread width and pattern	15
15.1	Setting the feed rate	16
15.2	Feed roller set up	16
15.3	Feed roller configuration	16
16	OPTIONAL Calibration Hopper	17
17	Product Calibration	18
18	Calibration catch and weigh test	19
19	OPTIONAL Grass Seed Deflector Kit	20
20	Fan Jet Pro Plus parts diagram	21
21	Fan Jet Pro Plus parts list (page 1 of 2)	22
22	Fan Jet Pro Plus parts list (page 2 of 2)	23
23	Notes page	24

## 3.1 General information

Congratulations on your Fan Jet Pro Plus purchase;



Please check the machine for any transport damage upon receipt and advise your supplier of any problems immediately. Late claims regarding any damage may be rejected.

## IMPORTANT

**This Operating Manual forms part of the machine and must be readily available for the operator who must read and follow the points covered before use**

## 3.2 Technical data

Model: Fan Jet Pro Plus

Hopper capacity: 65 litre or 130 litre

65 litre machines: Net weight: 40kg Dimensions (W x D x H) 50 x 56 x 108cm (boxed 52 x 58 x 110cm)

130 litre machines: Net weight: 45kg Dimensions (W x D x H) 60 x 60 x 123cm (boxed 62 x 62 x 128cm)

Max. spreading width: 24 m

Recommended working width: 12-24 m

\*Operating Voltage 12v; Power requirement 30 amps Motor outputs: 360 watt

Max. disc speed: 3700 rpm

\*Noise level: 80dB

## 3.3 Intended use

This 12V applicator has been designed for the agricultural, horticultural and amenity sector to apply large dense slug pellets from 12m to 24m and if fitted with the optional feed roller kit various small seeds depending upon the seed density and can be mounted to operate facing forwards or backwards.

Any other use is considered to be unintended and the manufacturer will not be liable for any resulting damage.

Often mounted to 24m self propelled crop sprayers or tractor with a front linkage.

Suitable for UTV vehicles and some ATV fitments OPTIONAL fitting kit available (see page 10)

**The operator alone bears the associated risk if used for unintended use.**

Intended use also includes compliance with the conditions for operation, maintenance, and repairs.

The implement may only be used, maintained and repaired by persons who have relevant experience and are aware of the risks involved.

The applicable accident prevention regulations as well as the other generally safety-related, occupational health and road traffic regulations must also be observed.

Specifications, descriptions and illustrations in this manual are accurate at the time of this publication but may be subject to change. This manual is correct at the time of printing but we reserve the right to change and improve them. This machine is designed with safety in mind.

Maintenance and servicing in accordance with this manual will ensure safe operation and reliability of your machine for many years.

Designed solely for use in agricultural and amenity operations (intended use).

The manufacturer is not liable for any resulting damage if the machine is used for any other purpose than the

Intended use also includes compliance with the conditions for operation, maintenance, and repairs prescribed within this instruction manual.

## 3.4 Unintended use

This machine is not designed to apply abrasive materials such as sand & grit or for applying salt products

**NOTE It is the responsibility of the operator to ensure the appropriate personal protection equipment is worn for the material being applied. If unsure contact the material supplier for more information.**

**Please contact us if you still have questions regarding the machine operation before use**

Stocks AG Ltd , Cromwell Road, Wisbech, Cambridgeshire UK

Tel: 00 44 (0) 1945 464 909 email: [sales@stocks-ag.co.uk](mailto:sales@stocks-ag.co.uk)

## E.C. DECLARATION OF CONFORMITY

Machine Type: Mounted Agricultural Implement - Pellet and Seed application broadcasters

Model(s):	Fan Jet Pro	All Variants & Versions
	Fan Jet Pro Plus	All Variants & Versions
	Fan Jet Twin	All Variants & Versions
	Fan Jet Mini	All Variants & Versions
	Fan Jet Duo	All Variants & Versions
	Turbo Jet	All Variants & Versions
	Rotor Meter	All Variants & Versions
	Rotor Meter Air Force	All Variants & Versions
	Micro Meter	All Variants & Versions
	Maxi Meter	All Variants & Versions

Serial No. ....

Manufacturer: Stocks Ag Ltd  
Cromwell Road  
Wisbech  
Cambridgeshire PE14 OSD  
United Kingdom

This is to declare that the above machine conforms to the relevant Essential Health and Safety Requirements of the Machinery Directive 2006/42/EC, implemented in the United Kingdom by Statutory Instrument 2008 No. 1597 – The Supply of Machinery (Safety) Regulations 2008 as amended.

The following standards have been applied in the design and construction of this machine:

BS EN ISO 12100: 2010	Safety of machinery – Basic concepts, general principles for design – Basic terminology, methodology.
BS EN ISO 4254-1: 2015	Agricultural machinery – Safety - General requirements
BS EN ISO 4254-8: 2018	Agricultural machinery – Safety – Solid fertilizer distributors.
BS EN ISO 13854: 2019	Safety of machinery – Minimum gaps to avoid crushing of parts of the human body.
BS EN ISO 13857: 2019	Safety of machinery – Safety distances to prevent hazard zones being reached by the upper and lower limbs.

The manufacturer stated above holds the technical file for this machine.

Signed on behalf of Stocks Ag Ltd

Name:  J Woolway

Date: 06th August 2020

Position: Managing Director





## UKCA. DECLARATION OF CONFORMITY

Machine Type: Mounted Agricultural Implement - Pellet and Seed application broadcasters

Model(s):  
Fan Jet Pro All Variants & Versions  
Fan Jet Pro Plus All Variants & Versions  
Fan Jet Twin All Variants & Versions  
Fan Jet Mini All Variants & Versions  
Fan Jet Duo All Variants & Versions  
Turbo Jet All Variants & Versions  
Rotor Meter All Variants & Versions  
Rotor Meter Air Force All Variants & Versions  
Micro Meter All Variants & Versions  
Maxi Meter All Variants & Versions

Serial No. ....

Manufacturer: Stocks Ag Ltd  
Cromwell Road  
Wisbech  
Cambridgeshire PE14 OSD  
United Kingdom

This is to declare that the above machine conforms to the relevant Essential Health and Safety Requirements of the Machinery Directive 2006/42/EC, implemented in the United Kingdom by Statutory Instrument 2008 No. 1597 – The Supply of Machinery (Safety) Regulations 2008 as amended.

The following standards have been applied in the design and construction of this machine:

BS EN ISO 12100: 2010	Safety of machinery – Basic concepts, general principles for design – Basic terminology, methodology.
BS EN ISO 4254-1: 2015	Agricultural machinery – Safety - General requirements
BS EN ISO 4254-8: 2018	Agricultural machinery – Safety – Solid fertilizer distributors.
BS EN ISO 13854: 2019	Safety of machinery – Minimum gaps to avoid crushing of parts of the human body.
BS EN ISO 13857: 2019	Safety of machinery – Safety distances to prevent hazard zones being reached by the upper and lower limbs.

The manufacturer stated above holds the technical file for this machine.

Signed on behalf of Stocks Ag Ltd

Name:  J Woolway

Date: 01st December 2020

Position: Managing Director

t. [+44 \(0\) 1945 464909](tel:+441945464909) f. +44 (0) 1945 464985 e. [sales@stocks-ag.co.uk](mailto:sales@stocks-ag.co.uk)



## 5.1 Machine identification



**The machine serial number decal is mounted on the steel chassis to one side of the hopper**

## 5.2 Warranty

We provide a 12 month warranty as of the date of invoice  
(your invoice for the machine which will serve as a warranty certificate).

This warranty is applicable for cases of material or construction faults and does not include parts that are damaged by normal or excessive wear.

Warranty expires if damage is caused by external forces, operator error, modifications, Jet washed or if the machine has not been used for its intended use.

Contact the company whom you purchased the machine from in the event of any problems, or before attempting any repair. If the base machine or the controls system are modified in any way this will void any warranty claim.

Please see our conditions of sale for full details a copy of which available upon request

Please record the machine serial number here;      S/N .....

Purchase date: .....      Dealer .....

## 6 Safety

**Ensure care is taken when lifting the machine**

**Safe lifting practice to be observed when handling as the net weight is over 25kg**



We advise safety shoes and protective gloves are worn when handling the machine

Assistance may be required when lifting or lowering the machine

Care to be taken to avoid crushing due to the weight of the machine.

When lifting or fitting the machine to the parent vehicle or implement ensure work is performed on level ground or flat surface to avoid slipping, stumbling or falling.

**PERSONAL PROTECTION EQUIPMENT** It is the responsibility of the operator or maintenance persons handling the machine to ensure the appropriate personal protection equipment is worn for the material being applied or to prevent contamination to the machine or the environment.

**WARNING**  Always observe all application standards and guidelines provided by the product manufacturer as some products may be toxic ! If unsure contact your supplier for more information.

**WARNING**  Ear protection required if working in close proximity to the machine as it exceeds 80dB

**NOTE** if unsure contact your seed or product supplier for more information.

If applying slug pellets or other toxic material and the parent vehicle has a closed cab the operator must ensure the cabin is always closed and the air filter system is in good order.

If fitted to an ATV or UTV vehicle ensure the stability of the parent vehicle is not affected when the machine is in use. If in doubt contact the manufacturers of the vehicle.

After working the machine ensure that any unused product is returned safely to its original packaging

Stocks AG Ltd. does not accept any liability for the storage and use of the material being applied

If unsure contact the material supplier for more information.

**WARNING**  Always adhere to the warning information as the disc rotates very fast and has sharp edges.

Granules leave the fan at very high speed in all directions and care must be taken by the operator to keep well clear and out of the spreading zone when the machine is in operation.

**It is the responsibility of the operator to ensure that no other persons enter the spreading zone whilst the machine is in operation.**



**WARNING**  Do not put your hands inside the hopper when the machine is running as the feed mechanism is powerful and can cause injury

The machine may only be used, maintained and repaired by persons who have relevant experience or a machinery dealer who is aware of any risks involved.

The applicable accident prevention regulations as well as the other generally safety-related, occupational health and road traffic regulations must also be observed.

The manufacturer is not liable for any damage resulting from unauthorised modifications and the use of components and auxiliary parts.

The machine must be checked regularly by the operator (before each use) for any damage loose bolts or electrical connections, vibrations, unusual sounds, and to ensure they function correctly. The machine must not be operated in wet weather conditions and not to be used during thunderstorms. Observe the generally applicable safety and accident prevention regulations.

Use the hopper tipping facility to empty the hopper of toxic materials to prevent harm to humans and animals after each use and prior to storage.

### WARNING

**AI-**  ways isolate the power supply if servicing or leaving the machine unattended.

**NOTE** UK users; more information regarding slug pellet and best practice available at

[www.getpelletwise.co.uk](http://www.getpelletwise.co.uk)

## 7.1 Emergency Stop instructions

In the case of an emergency always switch off the main power switch on the control panel and isolate the power supply immediately by disconnecting the power cable

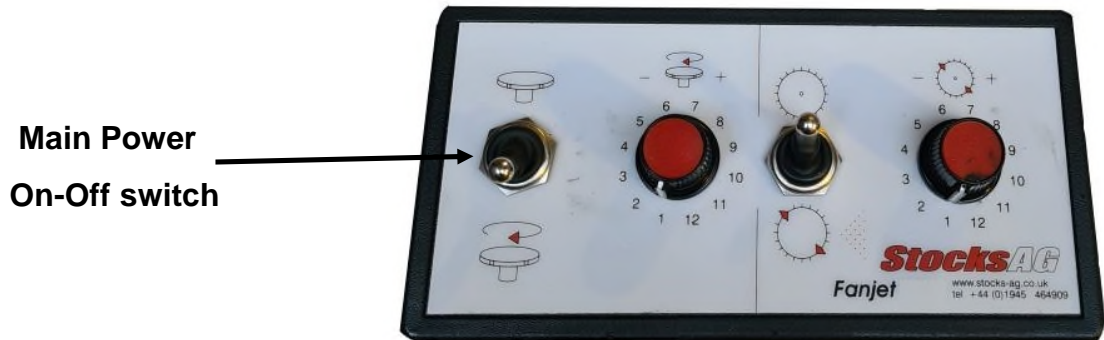

## 7.2 Maintenance

### WARNING

Always ensure the power supply is disconnected before any maintenance work or cleaning of this machine.

Suitable protective clothing must be worn (See page 6)

**DO NOT JET WASH THIS MACHINE**



The machine must be checked regularly by the operator for any damage loose bolts or electrical connections, vibrations, unusual sounds, and to ensure they function correctly.

#### Before use;

1. Ensure the machine is securely mounted
2. Check the power supply
3. Check the feed block assembly's to ensure the feed rollers are clean and replace any worn feed rollers
4. Check the feed rollers rotate freely before starting work

#### Daily checks;

1. Check the disc to motor shaft socket screws on the lower side of the spinning disc to ensure they are tight and the spinning disc turns with the motor
2. Check the stainless disc for any wear or distortion and replace prior to use if necessary.  
Replacement vane kits available; Part number FJ009A
3. Check the feed block assembly's to ensure the feed rollers rotate freely

#### After each use;

1. Empty hopper before removing the feed block assembly and clean the machine thoroughly ensuring all pellets residue has been cleaned from the hopper feed rollers and body of the machine.
2. Store in dry conditions to protect the machine and control system from moisture

**WARNING ** Always observe all guidelines provided by the product manufacturer with regards to handling storage and disposal of products as some may be toxic !

## 8 Safety WARNING decals

Important ; Be aware of the safely warning below which are all relevant to this machine



### **WARNING** ⚠

Read and understand the Operators Manual instructions before operating this machine

Operator errors can result in serious injury



### **WARNING** ⚠

Danger due to thrown or flying objects  
Always maintain a safe distance whilst the machine is in operation



### **WARNING** ⚠

Risk of injury

Possible trapping point when tipping hopper



### **WARNING** ⚠

Risk of injury

Be aware the feed mechanism is powerful and can cause serious injury



### **WARNING** ⚠

Keep Clear

Maintain a safe distance from the machine when in operation

Wear the appropriate protective personal equipment



### **WARNING** ⚠

Do Not Jet Wash

This machine is not designed to withstand Jet Washing !

## 9.1 Clearing a blockage

Switch off the main power switch on the control panel

Ensure the parent machine is stationary, switched off, and parked on level ground

Ensure the main power switch on the control panel is off and unplug the 2 core power supply cable from the control box or disconnecting the power cable from the vehicle battery.

**Ensure appropriate personal protection equipment is worn for the product being applied**

**Ensure any product removed is put back into its original container**

**Care to be taken not to spill any product that could contamination the environment.**

Empty the hopper of any remaining product

## 9.2 Hopper removal

Removing the hopper for cleaning and maintenance

Ensure the hopper is completely empty and free from any product residue **Ensure appropriate personal protection equipment is worn for the product being applied**

Release the rubber lid retaining straps and remove the lid. The hopper can then be lifted away after removing the retaining plate(s) from within the hopper by releasing the M8 external fixing nuts and washers.

**NOTE** When replacing the hopper ensure the Gasket fitted under the base of the hopper is in good order  
Replace if damaged; part number FJ017S

## 9.3 Storage

Disconnect the power supply by unplugging the power cable or removing the fuse in the power cable if storing the machine for long periods.

**It is the responsibility of the operator to ensure the hopper is empty after each use and cleaned thoroughly before storage.**

Store in dry conditions to protect the machine and control system from moisture

Always clean and spray electrical connectors with a moisture repellent spray when not in use for long periods.

Ensure feed shutters are free to operate following periods of storage

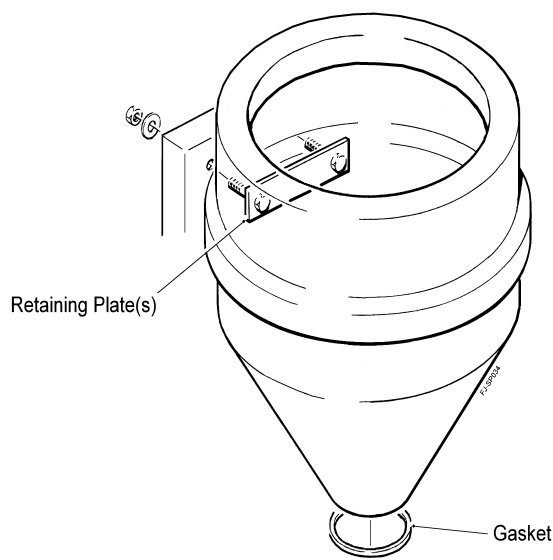

## 9.4 Optional PVC Waterproof Covers

Heavy duty White PVC cover fitted with eyelets and bungee cord for easy attachment

65L Waterproof PVC Cover **Part No. LC65**

130L Waterproof PVC Cover **Part No. LC130**

**Available through your local Stocks AG dealer**

## 9.5 Disposal

**Ensure that any persons handling the machine are aware that the machine may have been used to apply toxic chemicals and so the appropriate personal protection equipment should be worn.**

Ensure the hopper contents have been removed and any toxic residue removed and put back into a sealed container or disposed of in accordance with the manufacturers guidelines to eliminate any possible contamination of others or the environment

**Always adhere to the local disposal regulations paying particular attention to the plastics, rubber, and electrical components.**

## 10.1 Fitting to a vehicle or parent machine

**Safe lifting practice to be observed when handling the machine as the net weight is over 25kg. Safety shoes and protective gloves to be worn when handling the machine**

With a full hopper the 65L machine could weigh in excess of 90kg and the 130L machine 95kg and so ensure the machine is securely attached to a suitably strong rigid mounting point. If unsure seek advice from the parent machine manufacturer or supplier. Locally fabricated mounting frames are not the responsibility of Stocks AG Ltd

**NOTE** the machines can be operate facing forwards or backwards. **Ensure the disc height is a minimum of 1 metre above the crop canopy or the ground** – more height may improve the maximum spread width.

Ensure the power cable is connected direct to the parent vehicle 12v battery and the fuse is fitted correctly.

## 10.2 Optional ATV Fitting Kit

**Part No. FJ-005-BKT (available through your local dealer)**

**WARNING**  Always check specification of any ATV rear carrier before ordering

**Many rear carriers will not have the load carrying capacity to support the weight of a fully laden Fan Jet mounted on an ATV kit.**

**Please check with your ATV supplier as modification may be available.**

The Stocks ATV Kit provides a quick and easy way to attach your Fan Jet to the rear carrier of your ATV. Designed as a universal fitment to elevate the Fan Jet to gain more height to the spinning disc. The formed steel base plate with quick fit clamps and jacking screws to mount the machine to the base plate and to adjust the angle of the disc when the ATV is fully laden. The kit includes an operator protection plate which bolts onto the back frame of the machine and a short power and connector cable to maximise the power at the disc motor.

These are to be fitted rather than the standard length cables supplied with the Fan Jet machine.

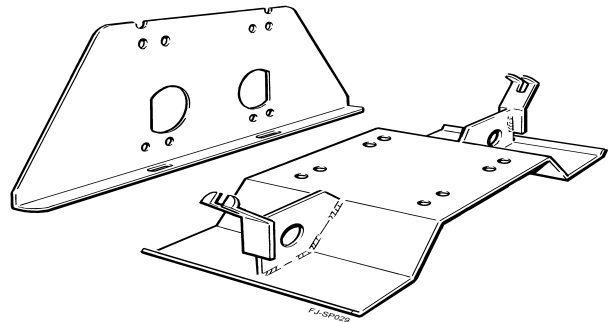

## 10.3 Optional UTV Fitting Kit

**Part No. FJ-005-UTV (available through your local dealer)**

The cost option UTV kit available for most UTV fitments

Offering a sturdy fitting option with 4 hooked anchor points with hand release fittings.

One piece tubular steel construction with detachable machine mounting plate.

Fixed fork lift point safe and easy lifting on and off of vehicle.

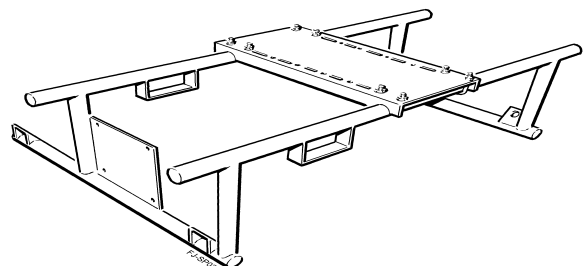

# 11 Mounting Plate

Mount the machine using the tipping base plate. This has 4 holes in the base to take M12 bolts (see below) use these to attach to the parent vehicle. The base plate can be repositioned to fit the holes in the back of the machine to attach to a vertical mounting point – use whichever is best for you.

**Ensure there is sufficient room to tip the hopper for emptying and ensure any potential trapping points are noted taking care not to trap hands or fingers.**

The tipping base plate is attached to the chassis by 2 bolts and spacers which act as the pivot, and a removable steel pin secured by an 'R' clip

There are 2 positions for the pin – use these to help level the Fan Jet.

**The machine must be on level ground or flat surface before tipping the hopper to avoid the hopper accidentally tipping forward once the tipping pin has been removed.**

To tip the hopper, remove the pin whilst supporting the hopper, lower gently when emptying the hopper.

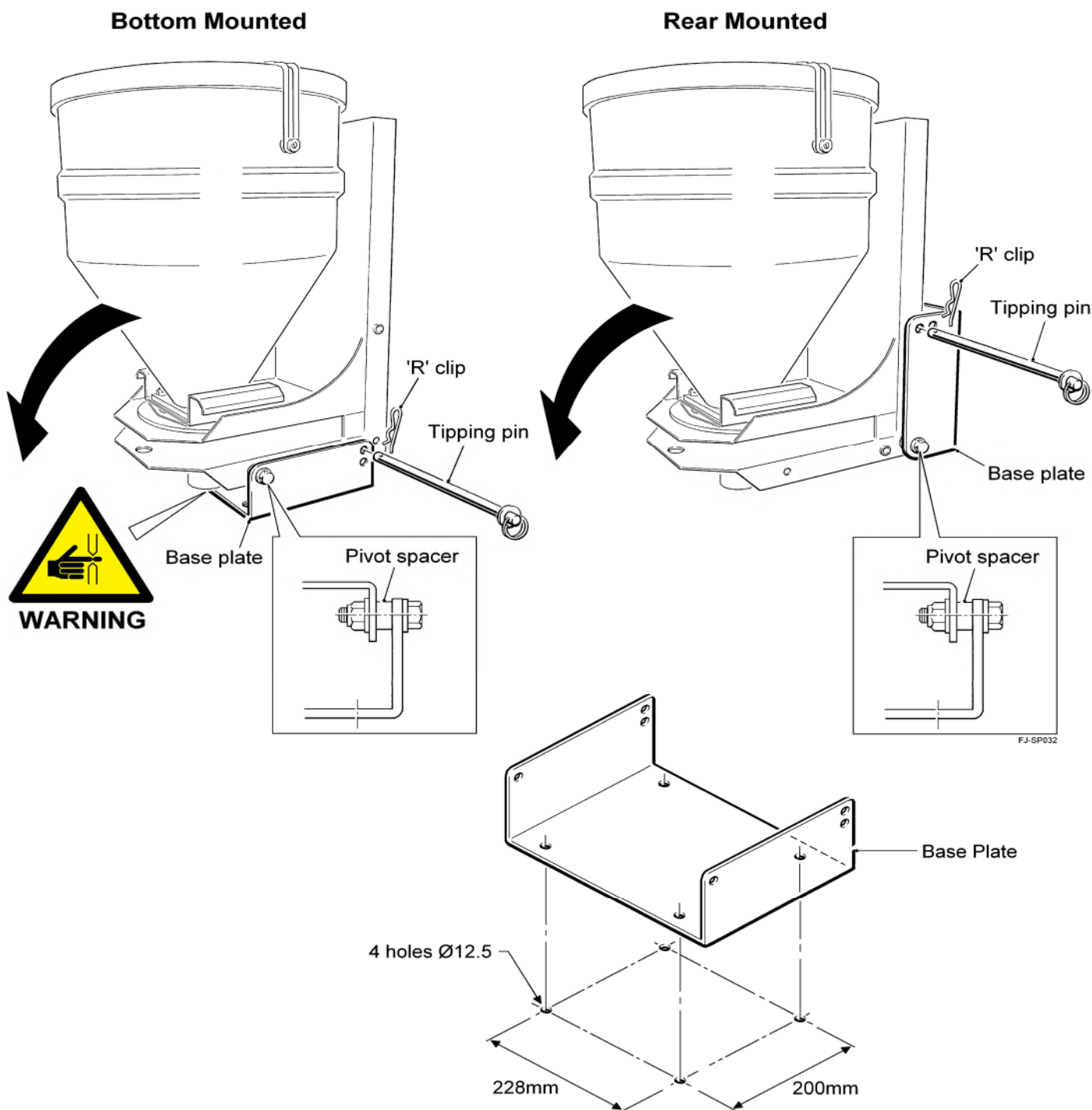

## 12 -1 Electrical Components



- |                  |                            |
|------------------|----------------------------|
| 1. <b>FJ110B</b> | Control Panel              |
| 2. <b>FJ107D</b> | 5m Fused Power Cable       |
| 3. <b>FJ108D</b> | 6m Control Connector Cable |
| 4. <b>FJ109E</b> | Tail Piece                 |
| 5. <b>FJ057D</b> | Disc Motor                 |
| 6. <b>TJ044B</b> | Feed Motor                 |

## 12 -2 Electrical Connections

Power requirement is 12 volts with a minimum continuous 30amp supply.  
The Fan Jet is supplied with a control console and all wiring

Ensure the power supply cable (**2**) is connected direct to the vehicle battery to ensure maximum power.  
Connect the positive wire (fused) to the positive (+) terminal and negative earth connection to the negative (-) terminal.

**NOTE** the disc should rotate in a clockwise direction when viewed from above.

**Control extension cables available (please enquire)**

**WARNING** ⚠ Failure to connect to the vehicle battery may result in control function problems and possible damage to the vehicle battery and charging system must be in good condition to achieve the best results.  
All cables and controls are fitted with matching plugs and sockets.

**WARNING** ⚠ any modification to the wiring, fuse holder or controls will invalidate any warranty claim and may affect the performance of the Fan Jet.  
**Always replace any blown fuse with the same amp rated blade type fuse as the original one fitted.**

## 13 Control Panel

A simple and effective manually operated electric control used to instantly start and stop the feed motor at headlands, and uses a dial control to set the feed motor speed and thus the application rate. It is not linked to forward speed so once calibrated the operator drives at a consistent forward speed to maintain the rate, or can manually increase or decrease application rates on the move using the dial.

The control panel is supplied with self-adhesive Velcro strips to attach the console to a suitable surface



The control console has 2 x toggle switches, and 2 x 12 position rotary dials and which are used to control the spinning disc and the variable speed 12v feed motor.

- A** DISC MOTOR - Power ON/OFF switch, the toggle switch upper position is OFF and the lower position ON
- B** DISC MOTOR SPEED CONTROL speed of the disc is controlled by the 12 position rotary dial with maximum speed achieved at position 12, lower settings used to reduce the disc speed and in turn the spread width.
- C** FEED MOTOR ON/OFF switch, the toggle switch upper position is OFF and the lower position ON
- D** FEED MOTOR SPEED CONTROL speed of the feed motor controlled by the 12 position rotary dial with maximum speed achieved at position 12 and by lowering the dial settings reduce the feed motor speed as required when calibrating

**WARNING** ⚠ Ensure the position and operation of the control panel does not affect the visibility of the operator or the ability to control the parent machine.

## 14.1 Setting the spread bias (factory set at 90 degrees)

**WARNING** ⚠ Ensure the power supply has been disconnected before carrying out work on the machine and the appropriate protective clothing worn

The complete feed mechanism can be rotated to bias the spreading arc to the left or right, and even out the spread pattern equally from the centre-line of the machine for in-field work, and as a headland control at field borders.

To adjust, undo the black plastic locking knob on the side of the machine and using the stainless steel motor cover, rotate the complete circular mechanism as far as required, moving the indicator dimple in the direction in which you want the arc to swing.

Re-tighten the locking knob.

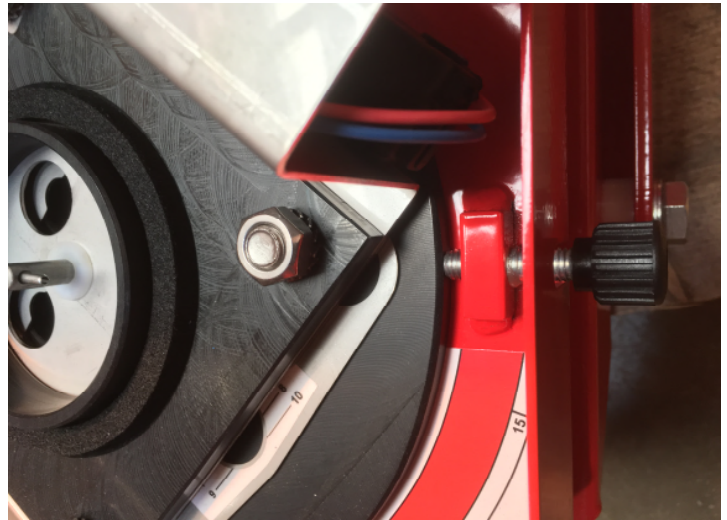

## 14.2 Setting the headland deflectors

Adjustable deflectors that reduce the exit aperture from the disc are incorporated into the Fan Jet to physically limit the spread width for headland control.

Undo the black plastic knob at the rear of the chassis and slide each deflector around the disc as far as required to prevent chemical granules from entering a watercourse or grass margin. Re-tighten the locking knob.

**NOTE** Use the motor disc speed dial in conjunction with the deflectors, and the bias adjustment.

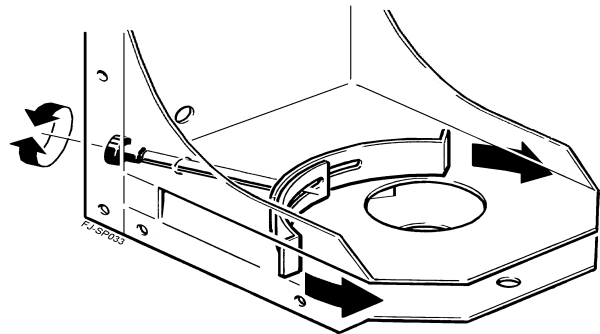

## 14.3 Spread width and pattern

**BASIC RULE.** The spread width is dependent upon the density of the granule or seed, and the disc speed (plus other factors).

Large, dense granules and seeds with a high disc speed give the maximum spread width – small, light granules and seeds will not spread as far.

**Other factors affect the spread width:**

**Type of slug pellet.** Typically, a large, dense hard pellet should spread further than a small, light, soft pellet, because it is comparatively heavy and does not powder on the disc. Typically, a 'wet' produced pellet will be hardest, a steam produced pellet mid range, and a dry produced pellet the softest. However, the line between traditional 'mini' pellets and 'full size' is blurred – most are of similar size and some lower priced dry produced pellets termed, as 'minis' are actually larger and heavier than more expensive wet produced pellets, and can have a good spreading characteristics.

**Seed varieties and dressings.** Different varieties and dressings will affect the density and the spread.

**Wind Conditions.** Dead calm conditions are the optimum; any wind will affect the width pattern.

**High forward speed.** The same as driving into a headwind of the same speed on a calm day, and this will peel the edges of the spread pattern backwards and inwards.

**Disc speed.** Altering the disc speed will affect the width and pattern. A higher disc speed will give a wider spread width.

**Disc vanes.** Ensure they are in good condition and not worn excessively. Replace if necessary.

**Low disc height.** Will not allow the product to reach its maximum width before gravity takes over.

**Low electrical power.** Will not allow the disc to reach full speed.

**High application rates.** Loads the disc more than a lighter rate and can slow it down.

**Incorrect disc angle.** It must be at least horizontal – not angled downwards.

**It is the responsibility of the operator to ensure that no other persons enter the spreading zone whilst the machine is in operation.**

## 15.1 Setting the feed rate

The feed rate is adjusted primarily by the motor speed. In addition, different feed rollers may be fitted that deliver different rates of material per revolution. Refer to the Calibration Procedure and with the appropriate feed rollers fitted, follow the instructions. You may have to change the feed rollers to obtain the application rate within a sensible forward speed range which is calculated during the calibration procedure.

### STANDARD 8 SECTION FEED ROLLS

Wide 8 section rolls for high rate application and large granules.

**The two feed rollers fitted should allow for typical slug pellets application rates.**

There are extra feed rollers supplied in the kit and appropriate spacers to allow 1, 2 or 3 feed rollers to be fitted to each feed block to help obtain the correct feed rate required for lower or higher outputs and varying speeds. Note Optional feed rollers are available, for more information please contact your local Stocks dealer.

**WARNING** ⚠ Always observe all application standards and guidelines provided by the product manufacturer as some products may be toxic ! If unsure contact your supplier for more information.

## 15.2 Feed roller set up

The feed rollers are easily changed by removing the feed block as follows.

**NOTE** Empty the hopper completely before doing this using the tipping facility.

- Undo and remove the 2 black plastic knobs holding the feed block in place
- Slide the complete mechanism out
- Undo and remove the 4 socket head screws on the end of the housing opposite the retaining plate and remove the end plate
- Slide the rolls and spacers off the shaft, and replace with the alternative rolls and spacers in the required combination
- Refit the end plates and re-fit the feed block and black plastic knobs.

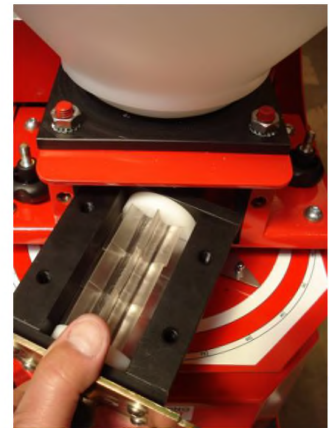

## 15 -3 Feed roller configuration

1 x 8 Section Feed Rollers

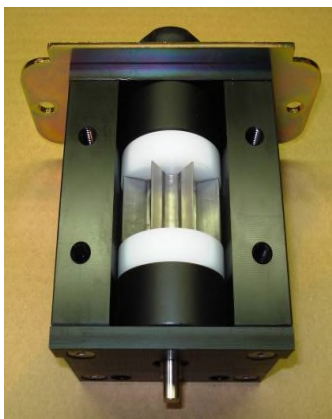

2 x 8 Section Feed Rollers

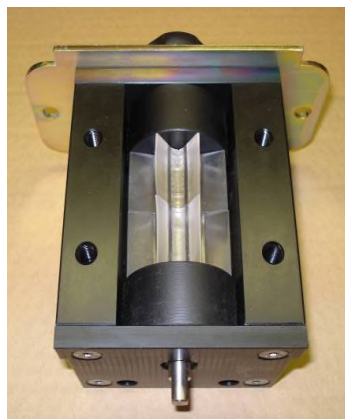

3 x 8 Section Feed Rollers

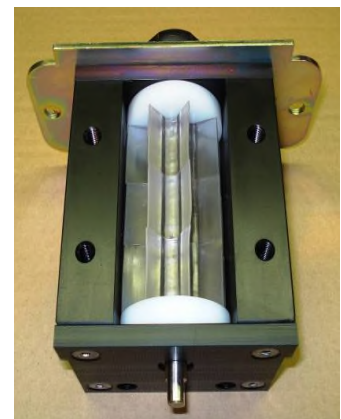

When re-fitting the end plates to the feed block after changing the configuration, the end plate should be able to fit flush with the feed block by hand, without having to pull it home with the socket head screws.

The assembled rolls and spacers should not be under compression.

**NOTE.** You should be able to rotate the feed shaft with your fingers – if it feels excessively tight, check the feed roller and spacer composition or call Stocks AG for advice.

## 16 OPTIONAL Calibration Hopper

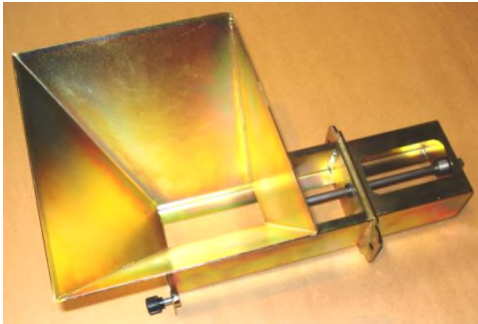

**NOT supplied with the machine**

**Available through your local Stocks AG dealer**

**Part No. FJ-005-CAL-DUO**

### Fitting Instructions

**1.** With an empty hopper, remove the feed block assembly from one of the Fan Jets.



**2.** Slide the Calibration Hopper into the Fan Jet in place of the feed block with the hopper uppermost, ensure the drive shaft aligns and secure with the supplied screw knobs.



**3.** Insert the (removed) feed block into the Calibration Hopper, ensure the drive shaft aligns by slowly rotating the feed shaft



**4.** Secure with the two small black PVC knobs supplied.



**5.** Place a suitable container under the Calibration Hopper to collect pellets whilst calibrating

# 17 Product Calibration

**NOTE** to ensure the maximum spread width is obtained when applying slug pellets hard dense pellets must be used.

Some smaller, lighter and less dense pellets may not reach the full width especially in breezy conditions, and with many pellets the pattern may be thinner towards the outer edges. Ensure conditions are good and the discs are a minimum of 1m above the ground or crop canopy. Ensure the spread width and pattern is adequate for your requirements before going to work.

You will have to perform a catch and weigh test to establish the flow rate of product, and will need a suitable container to collect the product being metered and an accurate set of scales to weigh kilograms and grams, and a timer.

**To establish the correct flow rate of pellets for your bout width, forward speed and application rate use the below formula;**

## Method

Use the following formula to establish the flow rate – this is a 1 minute catch test universal for all machines, products, widths and speeds.

$$\frac{\text{Application rate (kgs/ha)} \times \text{forward speed (kph)} \times \text{spread width (metres)}}{600} = \text{Flow rate in kgs per min}$$

### Example 1.

The required application rate is 25 kilograms per hectare. The target forward speed is 10 kilometres per hour. The bout width is 6 metres wide.

$$\frac{25 \text{ kgs/ha} \times 10 \text{ kph} \times 6 \text{ metres}}{600} = 2.5 \text{ kgs per minute flow rate}$$

### Example 2.

The required application rate is 5.5 kilograms per hectare. The target forward speed is 12 kilometres per hour. The bout width is 4.25 metres wide.

$$\frac{5.5 \text{ kgs/ha} \times 12 \text{ kph} \times 4.25 \text{ metres}}{600} = 467 \text{ grams per minute flow rate}$$

**NOTE** Machines are supplied from factory with two feed fitted in each feed block assembly  
This combination suits most slug pellet applications  
If lower rates required then 1 feed roller per feed block assembly can be fitted  
For higher rates or if say traveling at high speeds such as UTV work the extra feed rollers supplied can be fitted to give 3 feed rollers in each

# 18 Calibration catch and weigh test

**The optional calibration hopper recommended when calibrating slug pellets or similar products.**

**See page 17 for more information**

If using the calibration hopper only put a small amount of product in the calibration chute - do not fill in case the feed rolls have to be changed to achieve the rate (kgs/min)

If no calibration hopper available only fill the hopper with a small amount of product and prepare to catch product spinning off the disc with a bag or sheet of some kind.

**Please refer to page 14 showing the control panel switches**

When you are ready to begin;

1. Turn the disc motor speed dial **B** to setting no.1 to ensure the disc is rotating at the lowest RPM
2. Switch on the main power/ ON Off switch **A**
3. Switch the feed motor switch **C** on for the duration required
4. Weigh the amount of product caught in kilograms
5. Refer to the calculated amount for your rate/width/speed required
6. Use the feed motor speed dial **D** to increase or decrease the rate accordingly and repeat the procedure until the correct output for your machine width and forward speed is reached.

RECORD THE SETTINGS FOR FUTURE USE

**NOTE** If you do not run the catch test for 1 minute – for example 30 seconds – then you only need to collect half the amount indicated in the calibration formula.

**NOTE Machines are supplied from factory with two feed fitted in each feed block assembly**

**This combination suits most slug pellet applications**

**If lower rates required then 1 feed roller per feed block assembly can be fitted**

**For higher rates or if say traveling at high speeds such as UTV work the extra feed rollers supplied can be fitted to give 3 feed rollers in each**

## 19 OPTIONAL Grass Seed Deflector Kit

**Part No. FJ-005-DEFLECTOR (available through your local dealer)**

Recommended if fitting to a grass harrow or similar implement.

Designed for Fan Jet Pro machines to enable the seed to be directed across the spread width rather than be spun out in an arc to help reduce wind disturbance.

Supplied with a two side arms (items 8 & 9) which enable the deflector kit to be fitted onto the existing Fan Jet chassis or frame.

The front flap is fully adjustable so that the correct angle can be set to suit the application required

**NOTE** The grass seed agitator (item 2) supplied must be fitted when applying grass seed

With two adjustable vanes (items 12 & 13) spread width can be limited to 2-3m working width.

Without the vanes fitted the Fan Jet will spread grass seed over a 6m working width

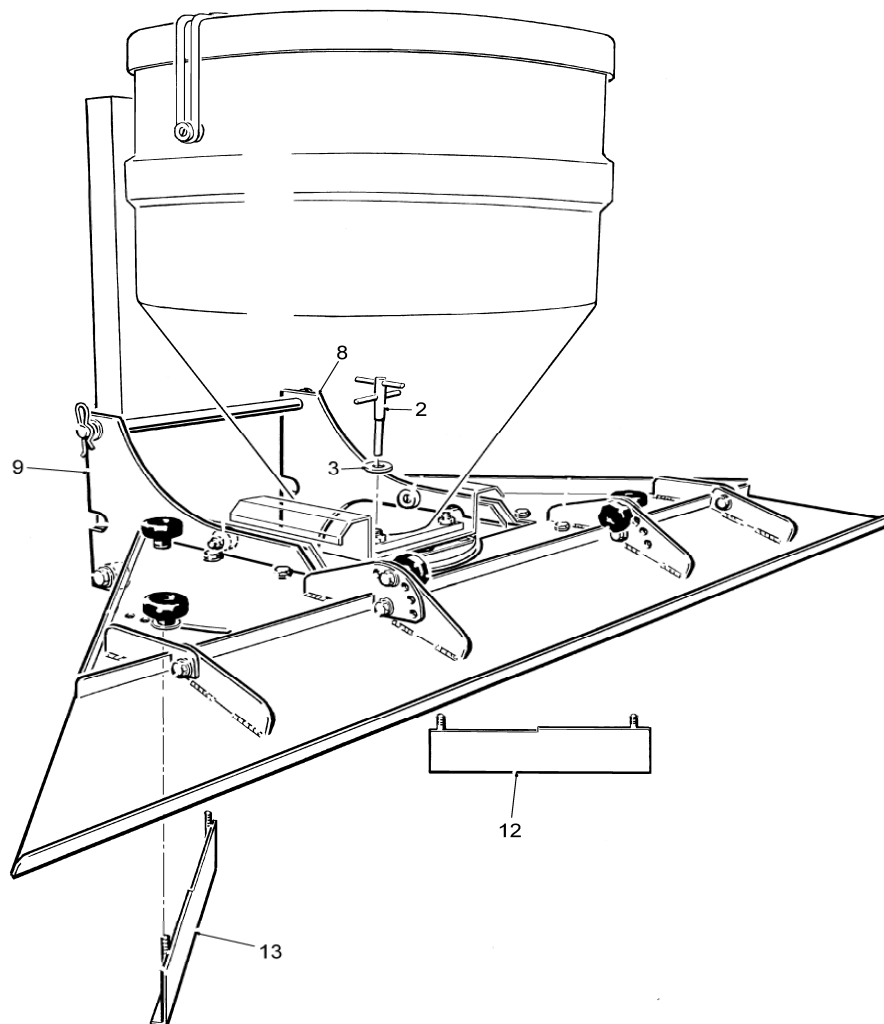

## 20 Parts drawing

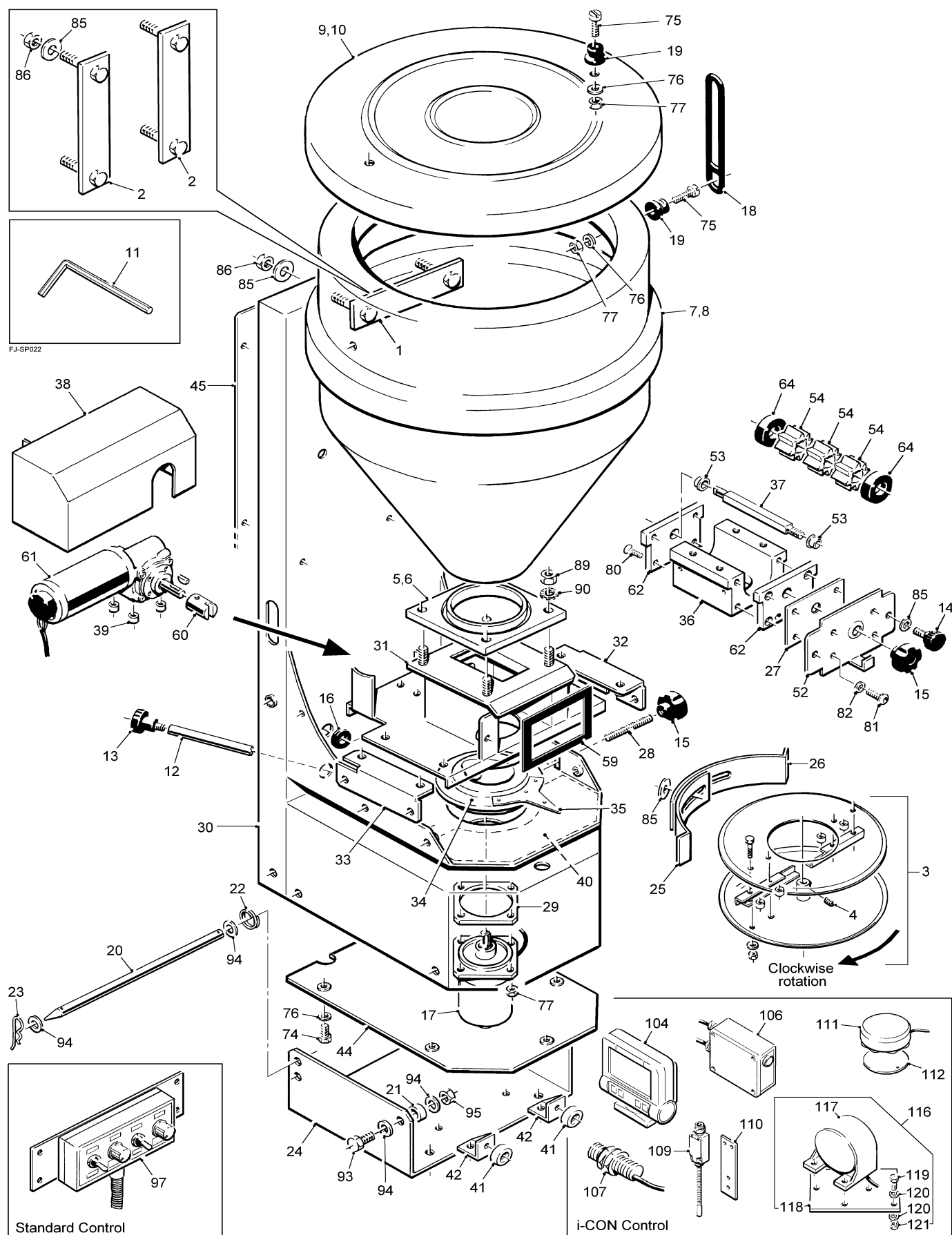

## 23 Parts list

### (Page 1 of 2)

Item	Part #	Description	Qty	Remarks
1	FJ003A	Hopper Bracket	1	65L only
2	FJ005A	Hopper Bracket	2	130L only
3	FJ007D	Disc Assembly	1	
4	FJ008A	M6x6mm Grub Screw	1	
5	FJ017D	Hopper Base Plate	1	
6	FJ017S	Base Plate Seal	1	
7	FJ026A-Ass.	65 Litre Hopper	1	
8	FJ026B-Ass.	130 Litre Hopper	1	
9	FJ027A-Ass.	65 Litre Hopper Lid	2	
10	FJ027B-Ass.	130 Litre Hopper Lid	2	
11	FJ028A	3mm Allen Key	1	
12	FJ030A	Deflector Knob Tube	1	
13	FJ032A	M8 x 8.5 Knob	1	
14	FJ032B	M8 x 15 Knob	2	
15	FJ033A	M8 Female Knob	2	
16	GR005	Rubber Grommet	1	
17	FJ057D	Disc Motor	1	
18	FJ103A-1	Rubber Tensioner	2	Qty x 3 on 130L
19	FJ104A-1	Bobbin	4	Qty x 6 on 130L
20	FJ415D	Tipping Pin	1	
21	FJ417A	Nylon Spacer	2	
22	FJ418A	Split Ring	1	
23	FJ419A	3mm "R" Pin	1	
24	FJ718A	Tipping Bracket	1	
25	FJ515A	Long Deflector	1	
26	FJ516A	Short Deflector	1	
27	FJ539A	Block Packer	1	
28	FJ732A	M8 x 85 Threaded Bar	1	
29	FJ736B	Motor Spacer Plate	1	
30	FJ700A	Chassis Weld Assembly	1	
31	FJ720A-Ass.	Cassette and Motor Mount Weld Assembly	1	
32-33	FJ722A	Fixing Bracket	2	
34	FJ734A	Rotary Feed Outlet	1	
35	FJ731A	Pointer	1	
36	GA108	Feed Block	1	
37	GA113D	Feed Shaft	1	
38	FJ730A-Ass.	Motor Guard	1	
39	TJ042A	5mm Spacer	4	
40	FJ119A	Quadrant Scale	1	
41	MM569	Buffer	2	
42	FJ719A	Buffer Bracket	2	
44	FJ711A-1	Base Cover Plate	1	
45	FJ717B	Back Cover Plate	1	

## 23 Parts list

### (Page 2 of 2)

Item	Part #	Description	Qty	Remarks
52	FJ540B	Feed Block Mounting Plate	1	
53	GA103	PVC Bush	2	
54	GA110B-A	8 Section Feed Roller (A)	2	(1 fitted )
54	GA110B-B	8 Section Feed Roller (B)	1	(1 fitted )
59	TJ040	Feed Block Seal	1	
60	TJ044B	Metering Motor		
61	TJ043A	Coupler	1	
62	GA109	Feed Block End Plate	2	
63	TJ131	4mm Allen Key	1	(not shown)
64	GA114	24mm Black Spacer	2	
65	MD005	Decal "FAN JET"	1	(not shown)
66	MD006	Decal "Plus"	1	(not shown)
67	MD052	Decal "Warning" Keep Clear - Wear PPE	1	(not shown)
68	MD050	"Warning" Decal Set- Thrown or Flying objects	1	(not shown)
69	MD002	Decal "STOCKS AG"	1	(not shown)
16	GR007	Rubber Blanking Grommet	1	(not shown)
74	M5-006	M5x12 Set Screw	5	
75	M5-012	M5x25 Slot Head CSK Screw	4	Qty x 6 on 130L
76	M5-014	M5 Flat Washer	9	Qty x 11 on 130L
77	M5-017	M5 Nyloc Nut	8	Qty x 10 on 130L
80	M6-007	M6x20 CSK Set Screw	4	
81	M6-008	M6x25 Button Head Set Screw	4	
82	M6-016	M6 Flat Washer	4	
85	M8-012	M8 Repair Washer	4	Qty x 6 on 130L
86	M8-017	M8 Nyloc Nut	4	Qty x 6 on 130L
89	M10-023	M10 Nut	4	
90	M10-026	M10 Star Washer	4	
93	M12-006	M12x40 Set Screw	2	
94	M12-008	M12 Flat Washer	6	
95	M12-014	M12 Nyloc Nut	2	
97	FJ110D	Control Panel	1	
98	FJ107D	5m Fused Power Cable	1	(not shown)
99	FJ108D	6m Connector Cable	1	(not shown)
100	FJ109D	Tail Piece	1	(not shown)
Items	104 to 121	Not supplied with this model	-	



**StocksAG**  
— RENOWNED FOR QUALITY

[illegible]